

# VULTURE

Type:	Manchi
Class designation:	Light cruiser
Predominant marking:	Violet
Length:	49 m (est.)
Displacement:	456 t (est.)
Armor:	480 (est)
Beam weapon:	sapphire laser (20 mw/s)
Missile weapon:	Plasma torpedo
Shield(s):	Fwd-2, Aft-1 (est.)
ECM:	--
Propulsion:	Unknown
Acceleration:	0.30 G
Turn (°/sec):	25
Date first sighted:	2309

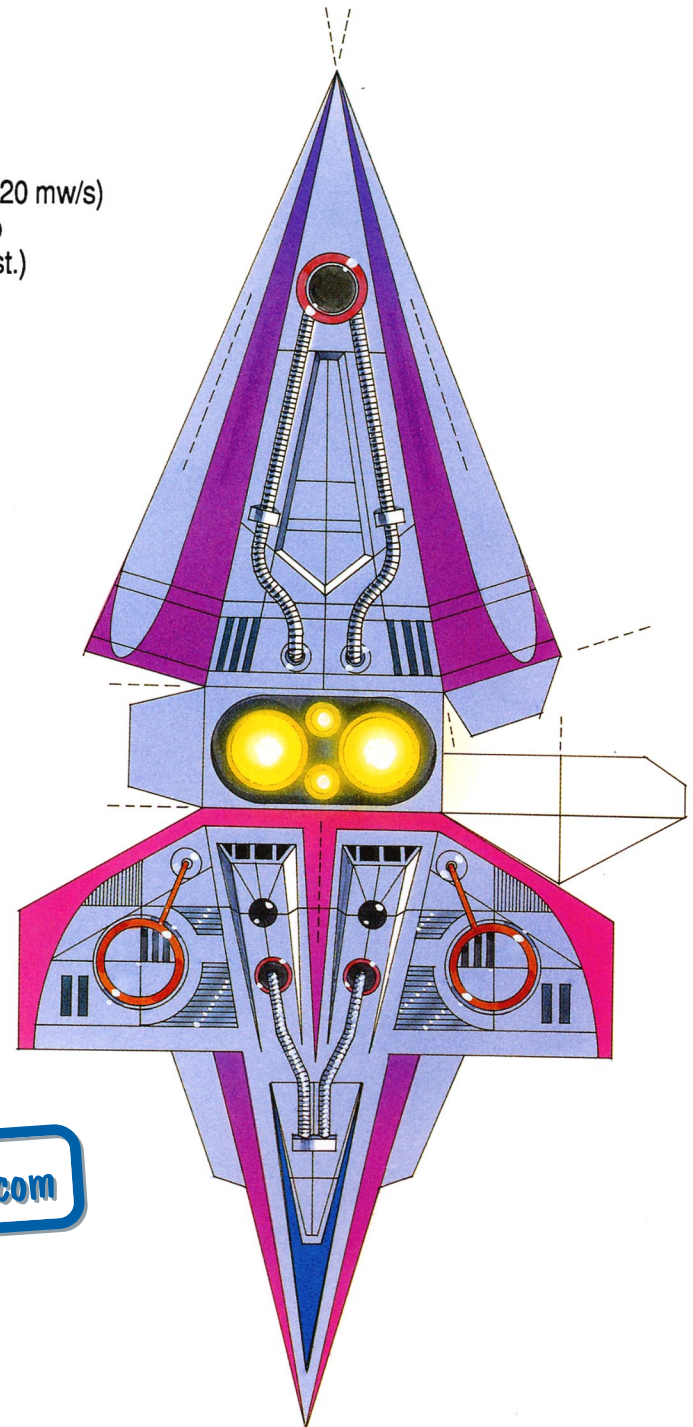
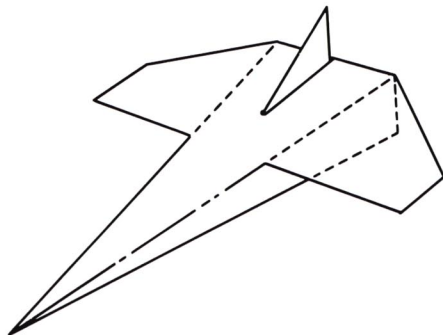
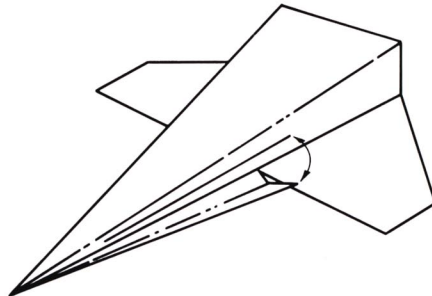
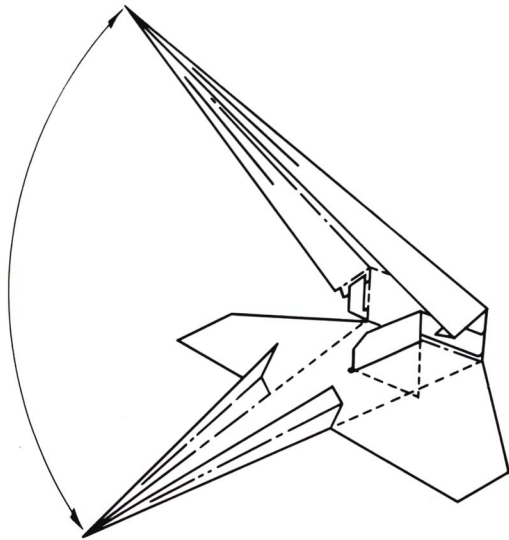

<http://www.replacementdocs.com>

In every encounter with Imperial ships, Manchi Vultures have attacked to kill, given no quarter, and have never accepted surrender. Exercise extreme caution.



# TITAN

Type:	Imperial
Class designation:	Heavy cruiser
Predominant markings:	Green
Length:	95 m
Displacement:	2,232 t
Armor:	900
Beam weapon:	particle (20 mw/s), turreted
Missile weapon:	Nova
Shield(s):	Fwd-3, Aft-3
ECM:	50%
Propulsion:	Imp. Shipyards positron drive
Acceleration:	0.15 G
Turn (°/sec):	10
Date introduced:	2304

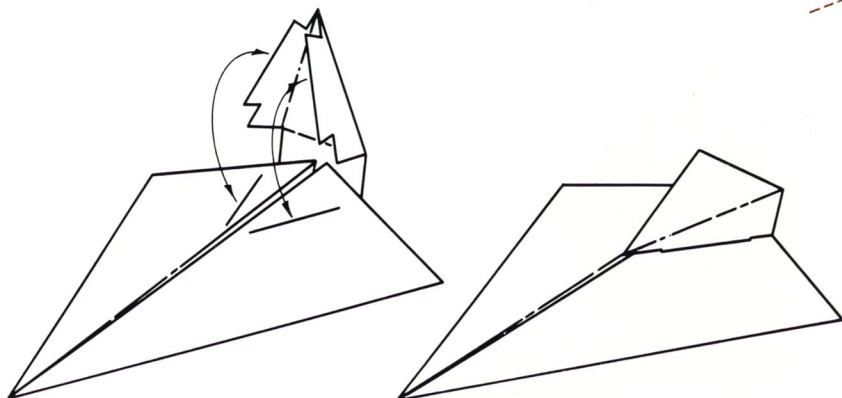
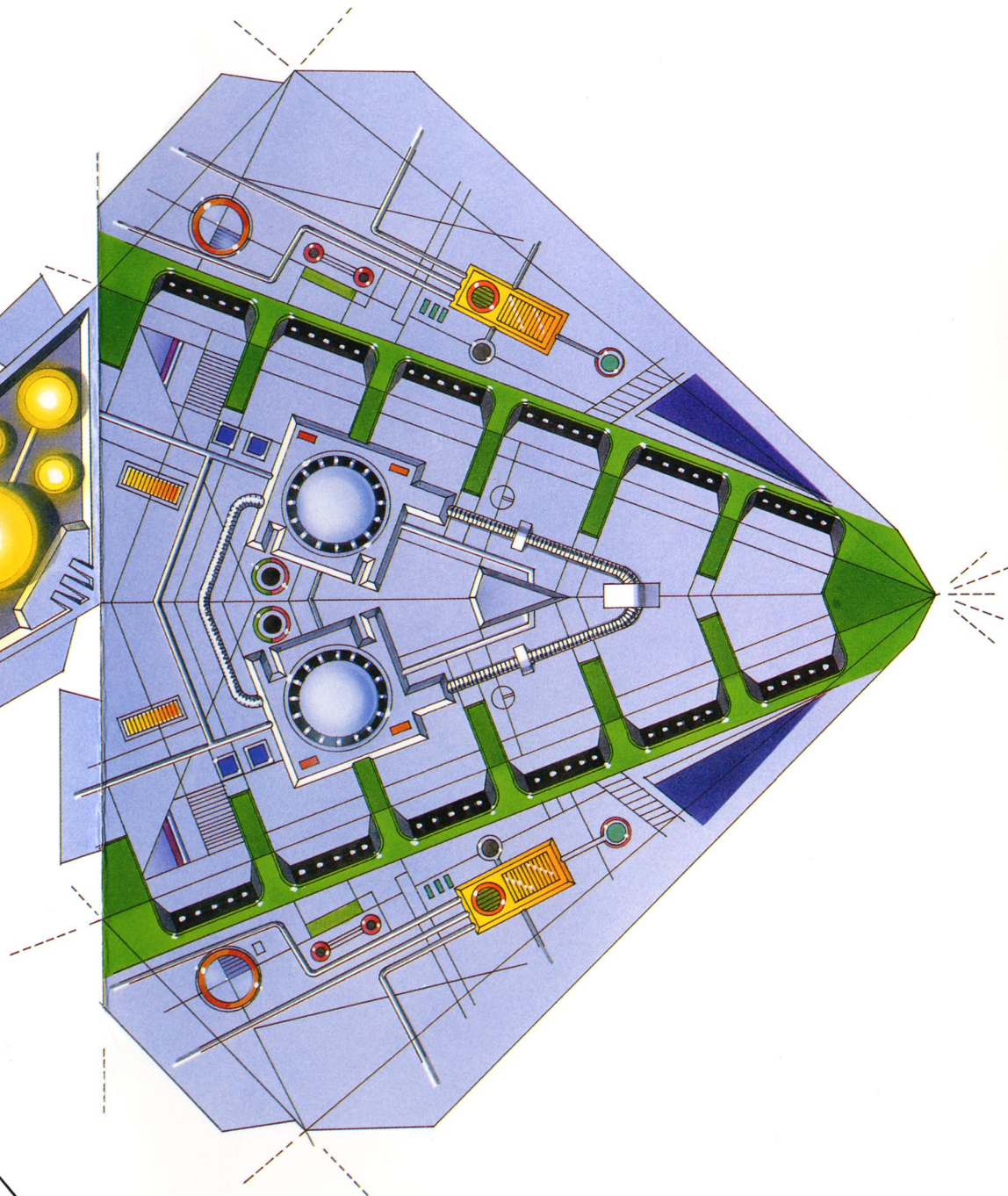
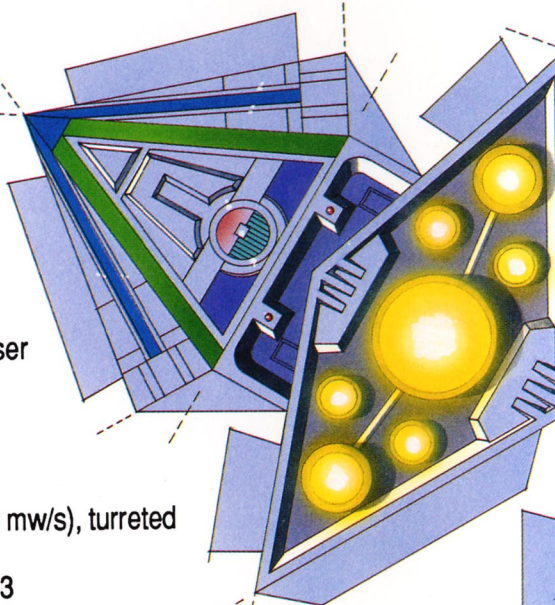
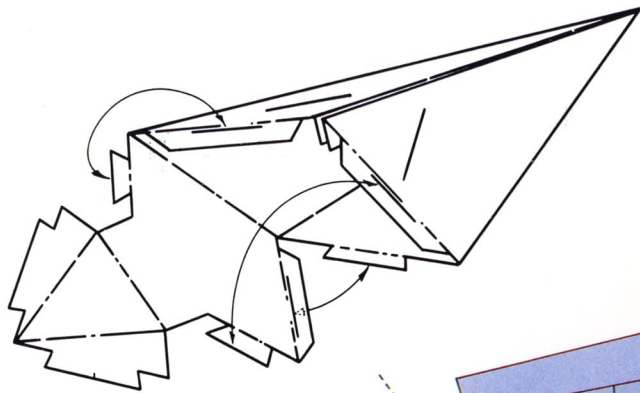

The glory of the Imperial fleet, the Titan-class cruiser reduces piracy in a system by its mere presence. Titans lack nothing in state-of-the-art armaments and defenses.